

THIS PAGE SUPERSEDES:

SECTION: 70-1
PAGE NO.: 1
DATE: 4-17-98

SALES AND ENGINEERING DATA

MODEL 7472

BALANCER 3 - 5 LB CAPACITY

SECTION: 70-1
PAGE NO.: 1
DATE: 5-26-00

The cable can be replaced in the balancer without disassembling. Release tension on spring completely so that the "V" shaped slot in the cable drum can be seen thru the opening in the bottom of the balancer. By sliding the cable up the "V" shaped slot to the cross opening in the drum, the cable can be withdrawn and a new one inserted in the same manner. The steel sleeve on the end of the cable locks in the "V" slot.

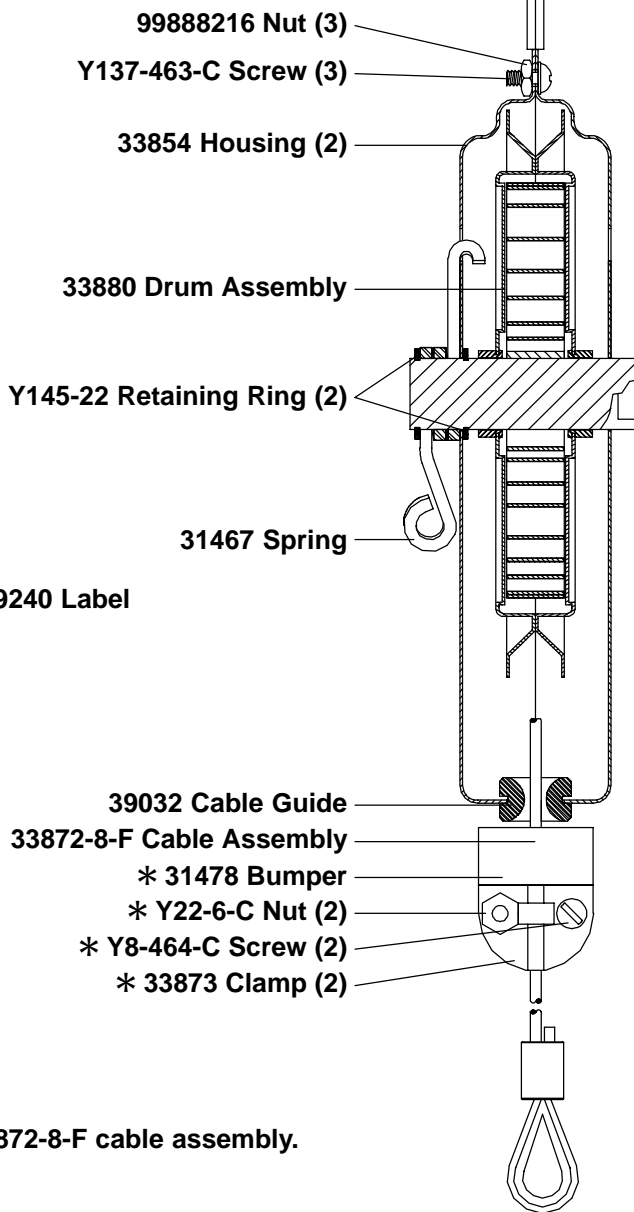
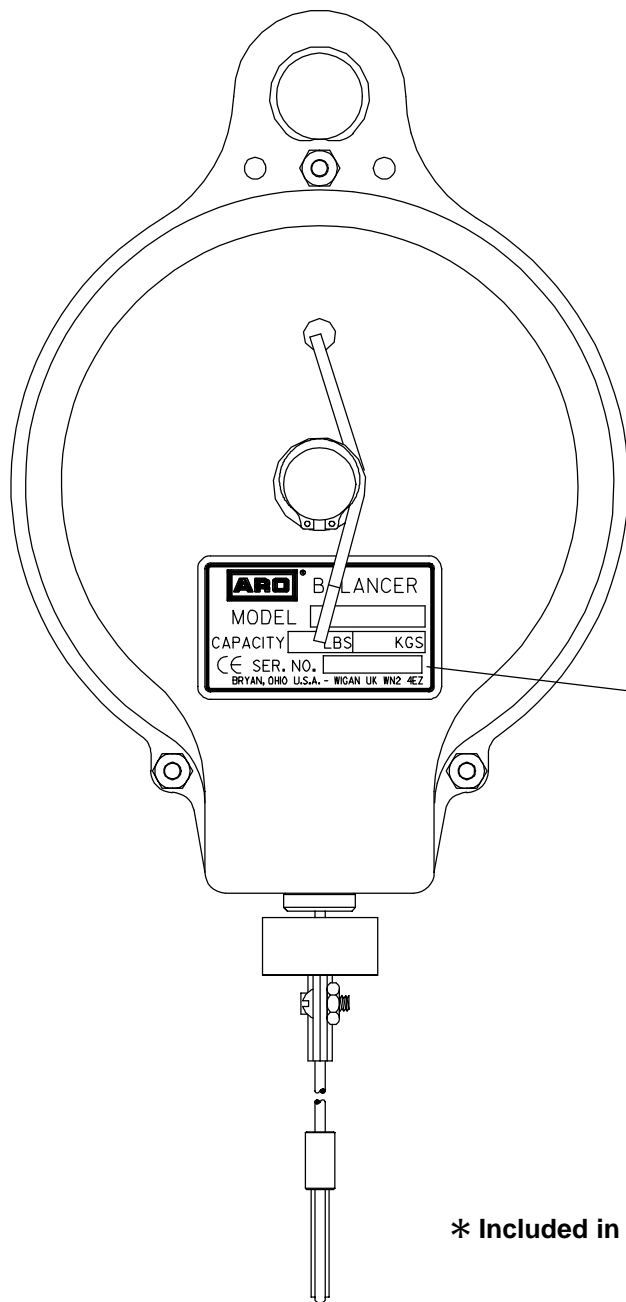
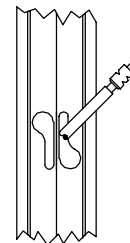

29240 Label

* Included in 33872-8-F cable assembly.



INGERSOLL-RAND COMPANY
P.O. BOX 151 • ONE ARO CENTER • BRYAN, OHIO 43506-0151
☎ (419) 636-4242 • FAX (419) 633-1674 ©2000 • PRINTED IN U.S.A.

INGERSOLL-RAND
FLUID PRODUCTS

SALES AND ENGINEERING DATA

SECTION: 70-1
PAGE NO.: 2
DATE: 12-9-96

MODELS 7072 & 7072-15

BALANCERS

THIS PAGE SUPERSEDES:

SECTION: 70-1
PAGE NO.: 2
DATE: 10-30-95

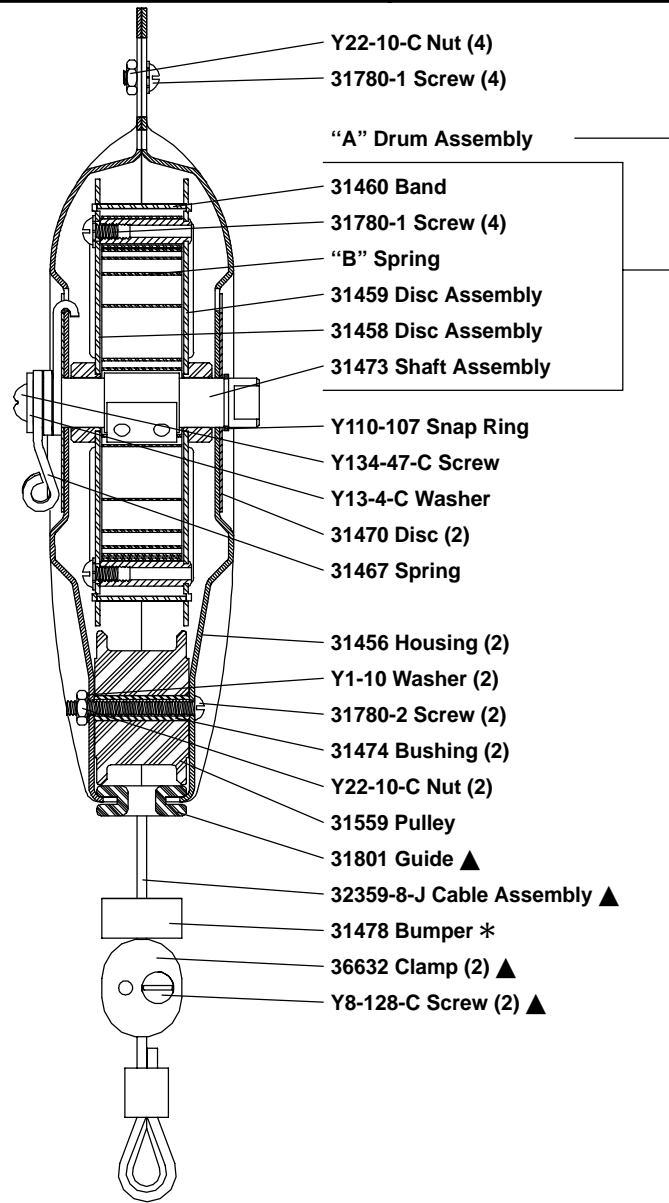
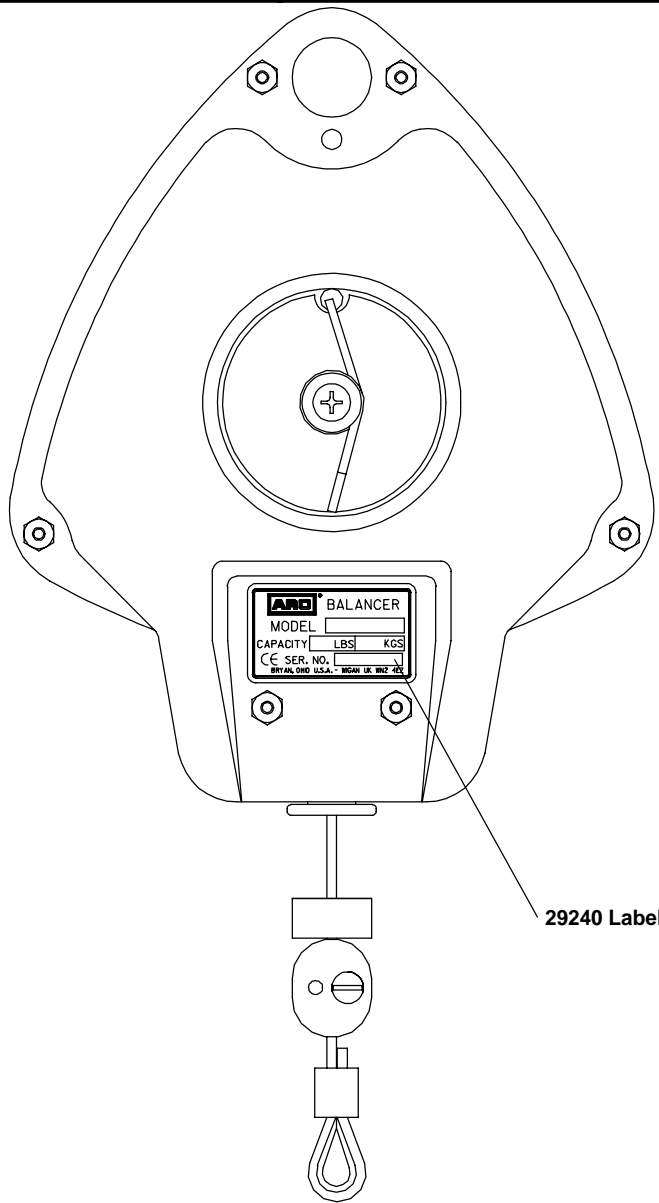

MODEL	"A"	"B"	CAPACITY
7072	31671-1	31471	6 - 10 lb
7072-15	31671-3	41797	11 - 15 lb

* Included in 32359-8-J cable assembly.

▲ Included in "A" drum assembly.

To release the tension or unwind the balancer, pull several feet of cable from the balancer, then press the eye of the spring located on the outside face of the balancer. Repeat this process until all of the cable has been extended and all tension has been released from the spring. Place the balancer in a vise, with the face of the balancer containing the label facing upward, and clamp on the flats of shaft assembly (31473). Remove screw (Y134-47-C), washer (Y13-4-C), spring (31467) and disc (31470). Remove four nuts (Y22-10-C) and four screws (31780-1). Remove two nuts (Y22-10-C) from two screws (31780-2) and lift off housing half. Remove four screws (31780-1) from drum assembly and remove disc assembly (31458). The cable is now free to be removed.

To reassemble, reverse the disassembly procedure. When replacing housing, be sure to assemble guide (31801) to housing.

The balancer is packed with grease at the factory and will require no further lubrication.

PN 49999-244



INGERSOLL-RAND COMPANY
P.O. BOX 151 • ONE ARO CENTER • BRYAN, OHIO 43506-0151
☎ (419) 636-4242 • FAX (419) 633-1674 ©2000 • PRINTED IN U.S.A.

INGERSOLL-RAND
FLUID PRODUCTS